

# Forest Snapdragon

Make a simple paper game then play it with your friends to learn more about the forest

instructions  
on next page

The Forestry Commission looks after more than 1500 woods and forests which provide timber, as well as being great places for people to visit and for wildlife to live.



 <p>Snake</p>	 <p>Spruce</p> <p>Can you name something important that trees give to people and animals?</p>	 <p>Holly</p> <p>Can you name a bird that lives in the forest?</p>	 <p>Deer</p>
 <p>Larch</p> <p>Can you think of an animal that lives in the forest?</p>	 <p>Forestry Commission England</p>		 <p>Oak</p> <p>Can you think of something people enjoy doing in the forest?</p>
 <p>Pine</p> <p>Can you think of a game you could play in the forest?</p>	 <p>Birch</p> <p>Can you name something we can eat that comes from the forest?</p>	 <p>Beech</p> <p>Can you think of a job that someone does in the forest?</p>	 <p>Ash</p> <p>Can you name something made of wood?</p>
 <p>Owl</p>			 <p>Spider</p>

## To make the snapdragon

1. Cut along the dotted lines to make a square. Place the square with the pictures facing down **A**.
2. Fold the four corners of the square into the centre **B**. This makes a smaller square **C**. Turn this square over **D**, and fold the four corners in again **E F**.
3. Fold all four corners up so that the points meet in the middle **G**, then push the first finger and thumb from each hand into the pockets of paper in each corner **H**.

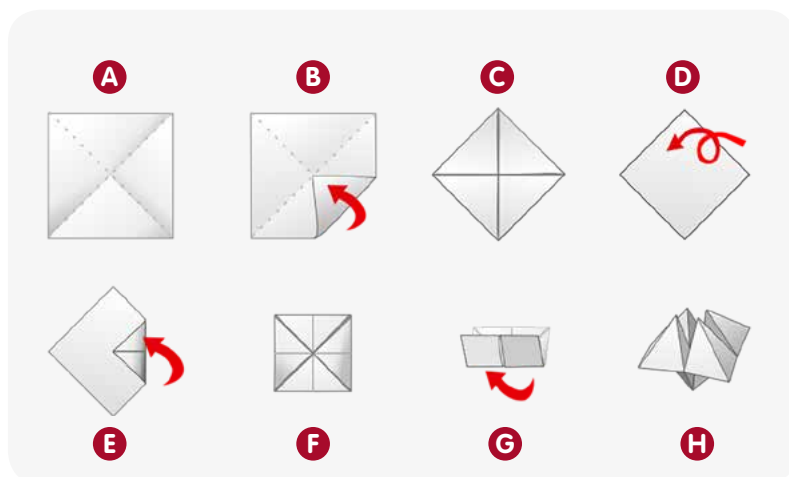

## To play with the snapdragon

Hold the snapdragon as explained above, then ask a friend to choose a forest creature from the four on the outside e.g. deer.

Spell out the name of the animal or bird, 'd-e-e-r' while opening and closing the snapdragon one way then the other.

Next, your friend chooses a tree from the four shown. Spell this out in the same way, then ask your friend to choose another tree.

This time, open up the snapdragon and ask the question under the chosen tree name.

Play again – how many different answers to the questions can you and your friends come up with?

**To find out more about how the Forestry Commission looks after your local forest, and the other public forests in England, please visit:**

[www.forestry.gov.uk/england-learning](http://www.forestry.gov.uk/england-learning)

On the webpage, you can also complete a short survey to tell us what you think of the snapdragon - we'd love to get your feedback.